



SEMI-AUTOMATIC SMART LOCK MANUAL



Catalogue

1. Installation instructions
2. Operation instructions
3. Networking instructions (optional)

1. Installation instructions

(1). Lock body change (Figure 1)

Adjust the direction of the lock body according to the actual opening direction, press the paddle up in the picture and rotate the ramp 180 degrees to complete the change.

(2). Install the lock body (Figure 2)

Check the upper and lower heaven and earth rod (the lock body can be selected without heaven and earth hook), and then put the lock body into the opened door hole and tighten the screws.

(3). Install the lock core (Figure 3)

Install the lock core and screw the lock core (note: take the key to test whether the lock goes smoothly)

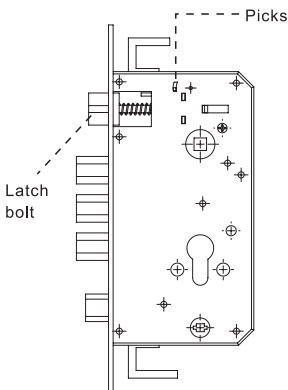

(Figure 1)

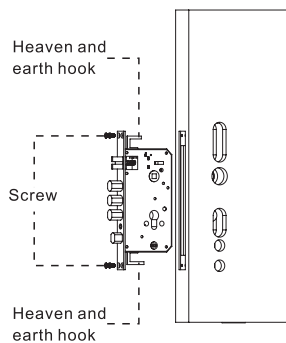

(Figure 2)

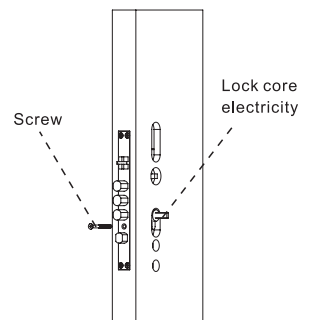

(Figure 3)

(4). Hand orientation change (Figure 4)

According to the actual direction of the handle (left or right), the front handle to: use the hexagonal key screw off the hexagonal screw and then turn the handle to the other direction after turning back the screw (1. Use the hand to prevent the finger line, 2. The arrow indicates the right arrow need to point to the handle direction left arrow to need down). Rear handle change: directly remove the cross screw and take the handle out and change to the other direction.

(5). Install the front panel (Figure 5)

Install screw sleeve, install square bar (short bump facing the door)

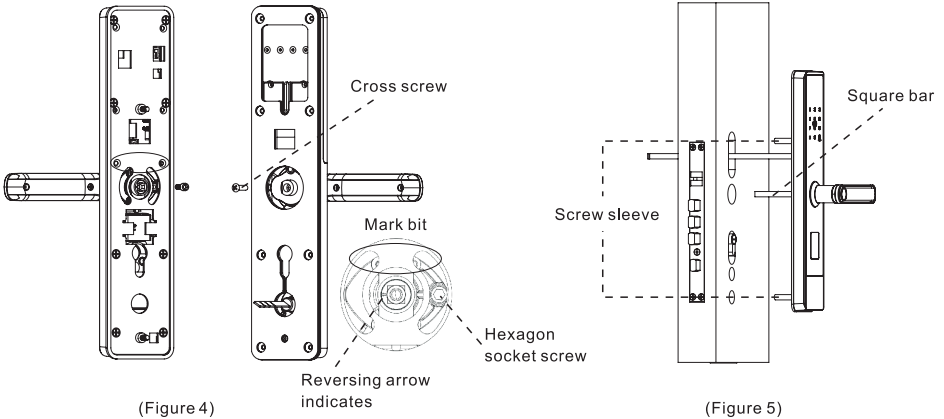

(Figure 4)

(Figure 5)

(6). Install the rear panel, cut the square bar, and lock the tail bar (Figure 6)

1)Cutting square bar: cutting about 2 cm away from the plane inside of the door, lock the tail bar: cutting according to the actual thickness of the door).

2)Plug in the cable, put the handle spring into the holding hole and screw the screw Wire (note that the screw is not too tight, 1. Visually check whether the main body of the front and rear panel is parallel.

3)Confirm whether the upper and lower switch lock of the handle is smooth) can fine tune the front and rear panels left and right, and complete the installation after tightening the screws.

(7).Effect effect of installation (Figure 7)

Note: For safety, please do not remove the key; please keep the mechanical key properly. Do not keep the mechanical key indoors and prevent the door lock as a spare emergency key.

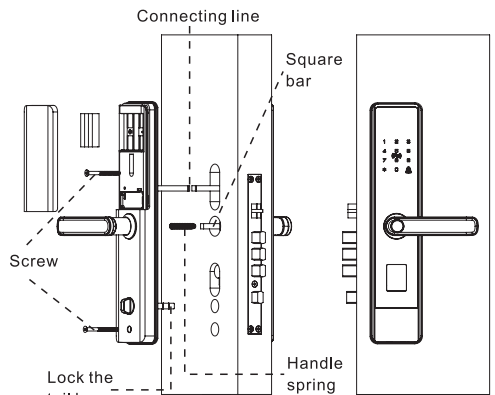

(Figure 6)

(Figure 7)

2. Operation description

(1). Parameter description

ORDER NUMBER	THE PARAMETER NAME	SPECIFICATION PARAMETERS
1	Comparison mode	1 : N
2	Collect header type	Self-learning capacitive pressing type fingerprint head
3	Head resolution was collected	508dpi
4	Refusal rate	< 0.1%
5	False rate	< 0.001 %
6	Fingerprint collection scope	± 36 0 °
7	Card type	M1
8	User capacity	Total capacity of 250 groups: up to 100 fingerprints, up to 100 groups of passwords, up to 100 cards.
9	Operation note	Scroll 600
10	Battery life	Open the doors 3,000 times
11	Working voltage	4.9V~6.0V, LV alarm voltage is 4.8V
12	Dynamic Power Consumption	1A (no motor action, no playback sound)
13	Quiescent dissipation	100 uA (average power consumption)
14	Proof time	3s (including the whole process of fingerprint acquisition, comparison and unlocking signal output)
15	Keyboard type	Touch induction
16	OLED display screen	0.96" OLED
17	External emergency power supply	5V1 A USB Emergency power supply
18	Anti-static ability	8 KV (contact type) 15 KV (non-contact)
19	Storage temperature	-25 °C ~ 80 °C
20	Working temperature	-25 °C ~ 70 °C
21	Ambient humidity	15 %RH~93%RH

(2). Initial state

(2.1) In the initial state, any fingerprint, password and card can be unlocked. Perform the factory setting operation.

(2.2) Multi-country language switch, input 888 # under the initialized state, and then input the corresponding code to switch the language, and press the # number to confirm:

CODE	LANGUAGE
3000	the Chinese language
3001	English
3002	complex font
3003	Russian
3004	Vietnamese
3005	Korean
3006	Arabic
3007	Portuguese
3009	Spanish
3011	Indonesian language
3013	Hebrew
3014	Turkic

Enter the door lock function management

• Add the administrator password for the first use

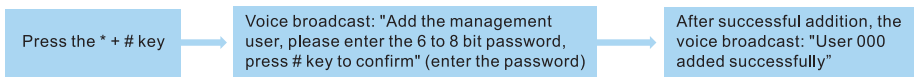

1. Add users

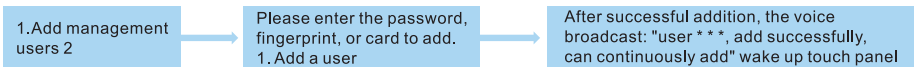

- Fingerprint: The user places the finger on the fingerprint sensor, and the voice prompts "Please press the finger again". The user puts the same finger on the sensor and continuously input it.
- Password: The user enters a 6 to 8 bit password and press # to confirm.
- Card: The user will put the card near the IC card sensing area of the touch keyboard, and the system will automatically read and save the card information.

Note: Number of managed users: No.000-009,10; number of ordinary users: No.010-249,250.

2. Delete users

(1) Verify that the deleted user

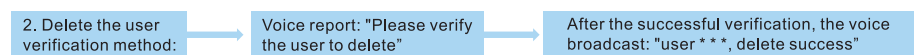

- Fingerprint: Place the finger removing the fingerprint on the fingerprint sensor.
 - Password: Enter the password to be deleted.
 - Card: The IC card to be deleted is close to the sensing area of the touch keyboard.
- If the user exists in the system, voice broadcast: "Delete deleted"; if the user does not exist, voice broadcast: "Operation failed".

(2) Delete users by the number

2. Delete the user after the number, voice broadcast: "user ***, delete successfully"

Voice broadcast: "Enter the user number to be deleted"

3. System Settings

(1) Time setting

Voice broadcast: "Please enter time" (input time format is: Year month time)

After successful setting, the voice broadcast: "Operation operation"

(2) Function setting

① Network settings

1. Network Settings

3. System Settings

2. Function Settings

After successful networking, voice broadcast: "successful operation"
3. System Settings 1. Time setting

(See the appendix of the instruction manual for the detailed operation of the connected products).
Note: The distribution network function only supports only one mobile phone for the distribution network. If the network configuration is entered again, the last distribution network data will be automatically cleared. Users should operate carefully.

② Door lock volume

3. System setting

2. Function Settings

2. Door lock volume [high]

③ Dual authentication

3. System Settings

2. Function Settings

3. Dual certification [customs]

Note: Dual authentication is only for ordinary keys. It requires two different ordinary user keys to unlock successfully. The administrator user can unlock directly.

④ skid alarm

3. System setting

2. Function setting

3. Anti-skid alarm [off]

Note: After the anti-skid alarm is opened, if the door lock is pried, the system will issue an alarm prompt: "Illegal user, illegal intrusion, the owner has been notified". If the device is connected to the Internet, an alarm message will be pushed to the phone.

(3) Restore the factory settings

3. System Settings

3. Restore factory Settings press # to confirm the resumption of factory Settings, voice broadcast: "Clear successfully", and restart the system

Note: After the factory setting is restored, the user data will be emptied.

4. Information query

(1) Number of users

4. Information query

1. Number of users

Voice broadcast: " Manage user ** ★ common with user ***"

(2) Read the records

-Query in order

4. Information query

2. Record query

1. Query in order

Note: The sequential query is to start up with the latest information, press the eighth key to query the next one, and the second key to query the last one.

-Query by time

4. Information query

2. Record the query

2. Check by time

Enter the time you want to query (date date)

3. Networking instructions (optional)



(1) Scan the QR code on the right to download the graffiti smart APP.

(2) Add the equipment

Press * + # on the door lock to verify that after the administrator enters the main system interface--press 3 System Settings--press 2 function Settings--press 1 network Settings.

(3) Open the mobile phone APP doodle smart and press the following operations:

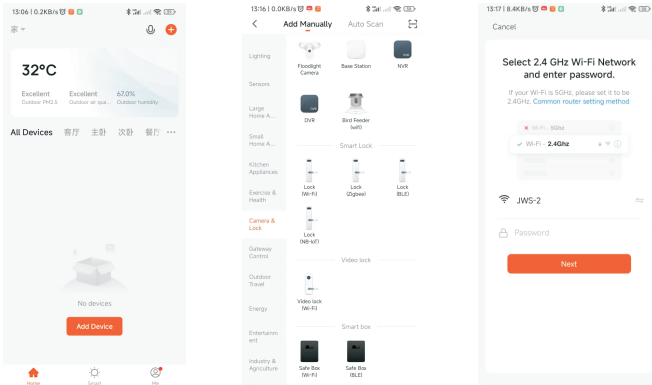

As shown in the figure above and below:

(3.1) Click the + number in the upper right corner to add.

(3.2) Click on the Security sensor-door lock (WI-FI).

(3.3) Connect the user home WIFI and enter the WIFI password and click Next.

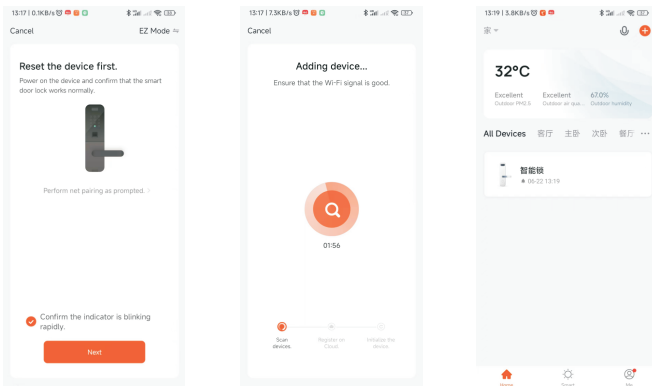

(4) Check the keyboard light flash and click Next.

(5) Wait for the connection until the door lock prompts the network is successful (this process may take a longer time, please wait patiently).

Tip: In order to ensure that the WIFI signal received by the lock is strong enough, the distance between the router and the lock should be kept within 5 meters, and only the 2.4 G band WIFI is supported.

4. Other instructions

(1) Initialization

Long press the back setting button for 5s, voice broadcast: "restore the factory setting, confirm please press # number key, cancel please press * number key", press # number key to confirm, the system restart to the initial state.

In the initial state, any fingerprint, password, and card can be unlocked. Implement the factory setting operation, and cannot clear the set door opening direction and torque parameters.

(2) Too low power level prompt

The power of the system is less than 25%. When unlocking the lock, the voice report is: "the power is insufficient", the battery can still be unlocked about 200 times, but please charge in time (or replace the battery).

(3) External USB emergency power supply

With USB emergency power supply, it takes about 30 seconds to open the lock.

(4) Illegal users shall report to the police

Continuous input 3 to 5 times to unlock the failure, voice broadcast: "illegal user, illegal intrusion, has notified the owner". After the fifth broadcast, the system is locked for 90 seconds, during which time it does not respond to any operation by the user. Unlock after 90 seconds.

(5) The virtual bit password

When using the password to unlock the lock, you can increase any number before and after the correct password, which can increase the security of the digital password, such as the password is "123456", you can input "426123456745" to unlock the lock.

Note: The system can only identify the first 16 digits.

(6) Version number

Enter the 999 # readable system version number.

Thank you for purchasing this product

Please read this instruction manual carefully before use

For future reference, please keep this manual subject to change without notice

The Company shall not undertake any accidents and hazards
caused by user error operation