



FOUR POST LIFT

Engineered with advanced AMGO technology—including stepless adjustable platforms—this premium series delivers exceptional versatility. Its oversized width provides ample space to accommodate multiple vehicles effortlessly, ensuring unmatched efficiency and comfort. These commercial-grade lifts are the ultimate productivity solutions for modern automotive service businesses.



A465/A465A
A465E/A465AE

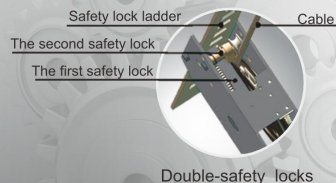

202501edition

SPECIFICATIONS

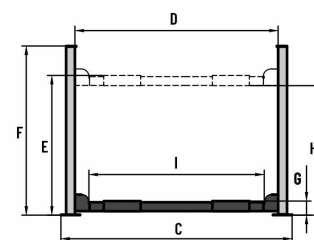
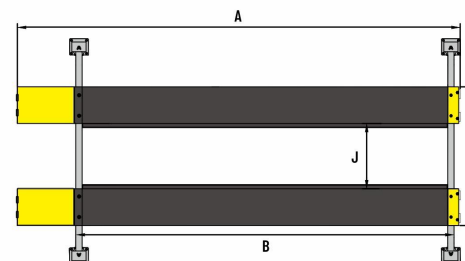

A465/A465E

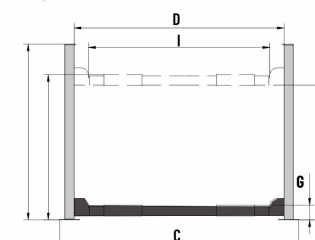
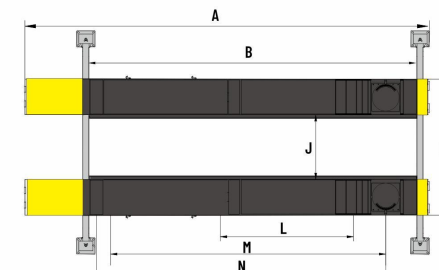

A465A/A465AE

Model	A465	A465A	A465E	A465AE
Style	General service	Alignment	General service	Alignment
Lifting capacity	6500kg	6500kg	6500kg	6500kg
Lifting time	79S	79S	81S	81S
Overall Length (Inc. Ramps)	A 6541mm	6528mm	7265mm	7252mm
Runway Length	B 5292mm	5092mm	6016mm	5816mm
Overall Width	C 3324mm	3324mm	3324mm	3324mm
Width Between Columns	D 2946mm	2946mm	2946mm	2946mm
Max. Lifting Height	E 1900mm	1950mm	1900mm	1950mm
Max. Lifting Height to top of runway	E 1830mm	1880mm	1830mm	1880mm
Overall Height	F 2189mm	2189mm	2189mm	2189mm
Minimum Height	G 200mm	250mm	200mm	250mm
Max. Underneath Height	H 1730mm	1730mm	1730mm	1730mm
Max. Lock Underneath runway	H 1660mm	1660mm	1660mm	1660mm
Drive-Thru Clearance	I 2592mm	2592mm	2592mm	2592mm
Width Between Runway	J 1194mm	1194mm	1194mm	1194mm
	85mm~Max.1385mm	85mm~Max.1385mm	85mm~Max.1385mm	85mm~Max.1385mm
Outside Edge of Runways	K 2210mm	2210mm	2210mm	2210mm
	1101mm~Max.2401mm	1101mm~Max.2401mm	1101mm~Max.2401mm	1101mm~Max.2401mm
Min. Four Wheel Align	L /	2396mm	/	2396mm
Max. Four Wheel Align	M /	4310mm	/	4310mm
Max. Two Wheel Align	N /	4472mm	/	5190mm
Motor	3.0HP	3.0HP	3.0HP	3.0HP
Gross Weight	1272kg	1544kg	1413kg	1634kg

AMGO Lift

www.amgolift.com

General Service Model



A465 A465E
(6500KG) (6500KG)

FEATURES

- Commercial-grade design;
- 24V safe electrical operation system;
- Stepless adjustable width between platforms;
- Integrated non-skid diamond platforms;
- Both auto-activating mechanical lock and air-release safety lock mechanisms;
- Dual safety devices mechanisms: both primary safety locks and cable-slack protection mechanism;
- High quality hydraulic cylinder design and manufactured at high standard.
- Well arranged oil hoses and cables to avoid being exposed outside.

Alignment Service Model

FOUR POST LIFT



A465A A465AE
(6500KG) (6500KG)



Electric control device with **UP**, **LOCK** and **DOWN** buttons.

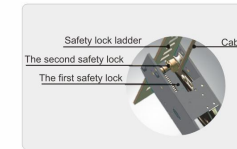

Double safety locks provide additional safety.



Oil-water separator and solenoid air valve are installed on the power side column.



Stepless adjustable width between platforms;



Non-slip diamond platforms come as standard.



Optional Platform extension kits add an extra 660mm length to the platform. Kits No..41403-01

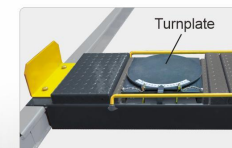

Optional Turnplate, Kits No. 40101. Each alignment lift need 2 units. Only for the model A465A A465AE

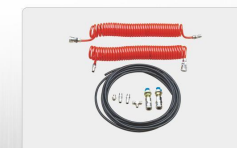

Optional Air Line Kits. Kits No.40102.

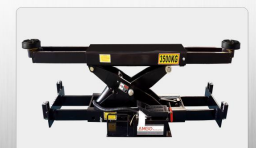

Optional Rolling Jacks RJ-8A: pneumatic hydraulic type 3,500Kg.