



CAPSULE STANDARD PRODUCT CATALOG



**MOBILE PREFAB
VACATION VILLA HOUSE**

Guangzhou Guose Intelligent Technology Co.,Ltd.

BRAND INTRODUCTION



AUTONOMOUS R & D TEAM

Guojue Intelligent Technology Co., Ltd. is committed to scientific and technological innovation. There are top design teams and manufacturing plants. The comfortable travel and accommodation products bring more possibility of travel and lifestyle.



HIGH -EFFICIENCY, HIGH QUALITY, HIGH COST PERFORMANCE

Do not play the foundation, apply all the terrain, do not destroy the ecological environment, no construction waste, ecological and environmental protection. 40 days in the factory, installation and disassembly, integrated transportation, 2 hours on -site installation, no secondary renovation, shortening the construction cycle, equipped with a full smart home appliance control system, panoramic view, and self -traffic.



PRODUCT QUALITY AND SERVICES ARE GUARANTEED

The main structure of the product is a special steel structure with strong structure design, which strengthens windproof and shock resistance. The main material uses high -intensity composite materials and external decorative galvanized plates, with high safety and strong protection. Professional sofflight designers create space design plans for customers. The professional planning team conducts planning and design according to the actual situation of the project and customer requirements, including consulting, overall planning, space design, and supporting facilities. Construction diagram, etc.

PRODUCT CORE COMPETITIVENESS



Unlimited terrain ecological development



Quality design suction sun drainage



The overall prefabrication is fast installation



Ultra -strong steel mixed 100 -year quality



TO OPEN THE INNOVATIVE ACCOMMODATION
MARKET OF CULTURAL AND TOURISM INDUSTRY

4 CORE ADVANTAGES
REBATE THE FORM OF RESIDENTIAL TRAVEL

HONORS AND CERTIFICATES





PRODUCT INTRODUCTION

The smart space capsule mobile house is widely used in tourism resorts, RV camps, creative parks, shops and other fields, and lay out ecological tourism, mobile real estate, mobile retail, and build a "mobile business opportunity" for special towns. Flexible application in different town needs. The cabin adopts an open design. The decoration style and pattern can be customized according to customer requirements!

TEAM INTRODUCTION

All -in -one structure system

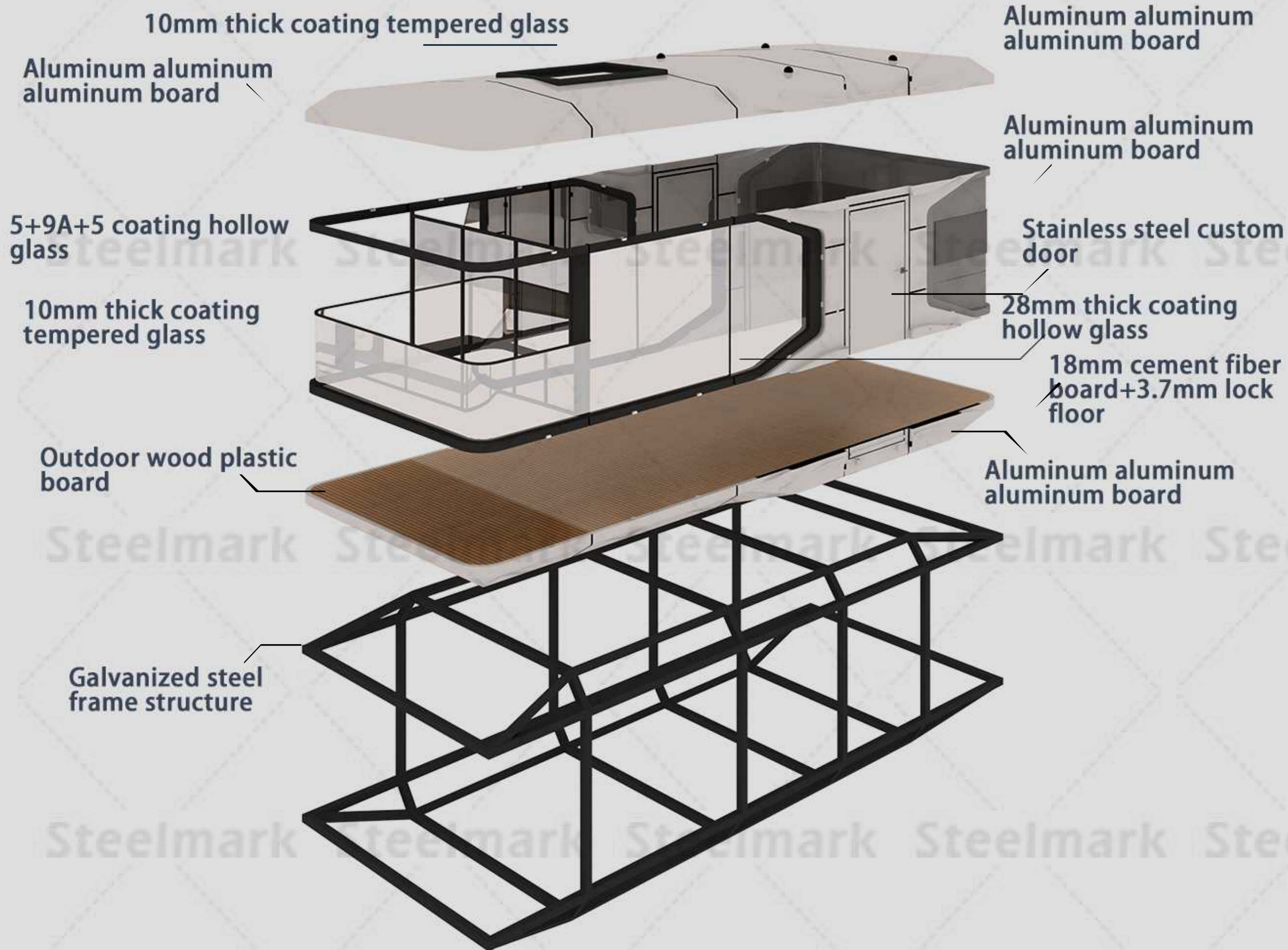

HOUSING SYSTEM

FLOOR SYSTEM

WALL SYSTEM

1. Super strong steel mixed, 100 years of quality

The main structure of the product is a special steel structure with strong structure design, which strengthens windproof and shock resistance. The main material uses high -strength composite materials and aluminum alloy shells, with high safety and strong protection. Typhoon above level 12, anti -corrosion prevention and moisture. Special thermal insulation and cold design, without fear of environmental conditions, can be minimum to minus 30 degrees.

2. Quality design, sucking and drainage

Prefabricated hostels, moving at any time, convenient and fast, personalized design in line with young people's curiosity about novelty, bringing a unique living experience. Through the regional culture of attractions, the national color integrated cabin uses healthy and high -quality environmental protection materials to build a convenient and fast green ecological house that can breathe, which is a building that makes people happy and enhances happiness, and meets people's demands in the landscape.

3. Overall prefabrication, fast installation

The intelligent integrated cabin is realized in the factory for 40 days of production, installation and disassembly, integrated transportation, 2 hours on -site installation, no secondary decoration, shortening the construction period, equipped with a full smart home appliance control system, a panoramic view, and its own traffic.

4. Unlimited terrain, ecological development

The all -in -one cabin does not play the foundation. It is suitable for all terrain, applicable mountains, seaside, and even sea. It does not destroy the ecological environment, no building waste, and ecological environmental protection. Further saving the foundation costs and reducing the requirements for geological conditions.

LIVE SHOW



PRODUCT SERIES

GS-A01

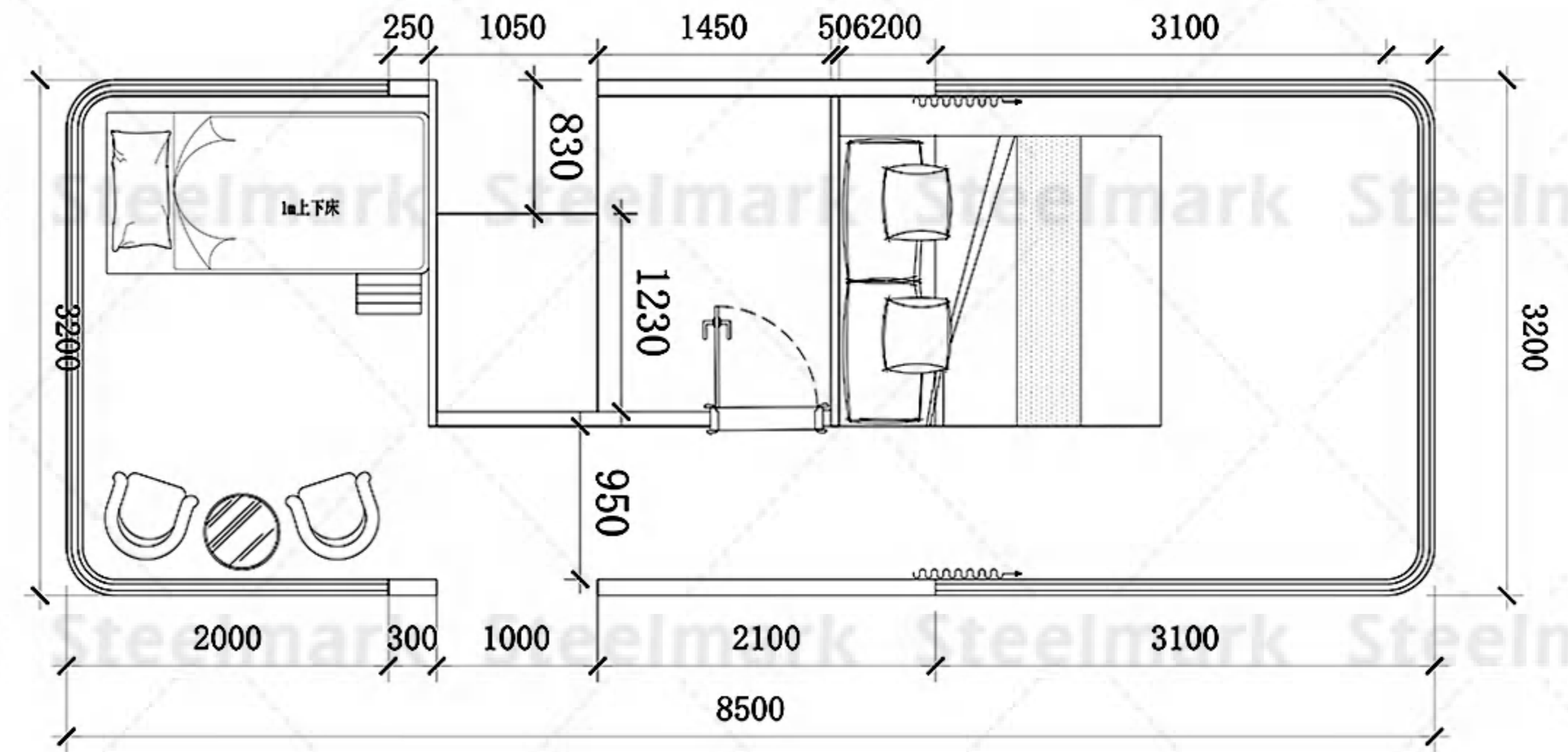

Product printmap

Note: The product continues to be upgraded and iterates.

MODEL	GS-A01 (8.5M PARENT -CHILD MODEL)	MAXIMUM NUMBER	4-6 PEOPLE
DIMENSIONS	L8500mm、W3200mm、H3300mm	MAXIMUM ELECTRICITY	12KW
LAND	27.2m ²	INDOOR GROUND LOAD	500KG/m ²

PRODUCT FEATURES

The space compartment uses a metal shell with a sense of technology and a single cabin with a 270-degree tempered glass; the viewing view of the viewing balcony is unobstructed; the whole house adopts Xiaomi intelligent control system, high quality, low energy consumption, and full intelligence. The products have been put into production in batches, and the product testing waterproof, insulation, insulation, and materials have reached international standards.

PHYSICAL DISPLAY OF PRODUCTS



PRODUCT EFFECT DISPLAY

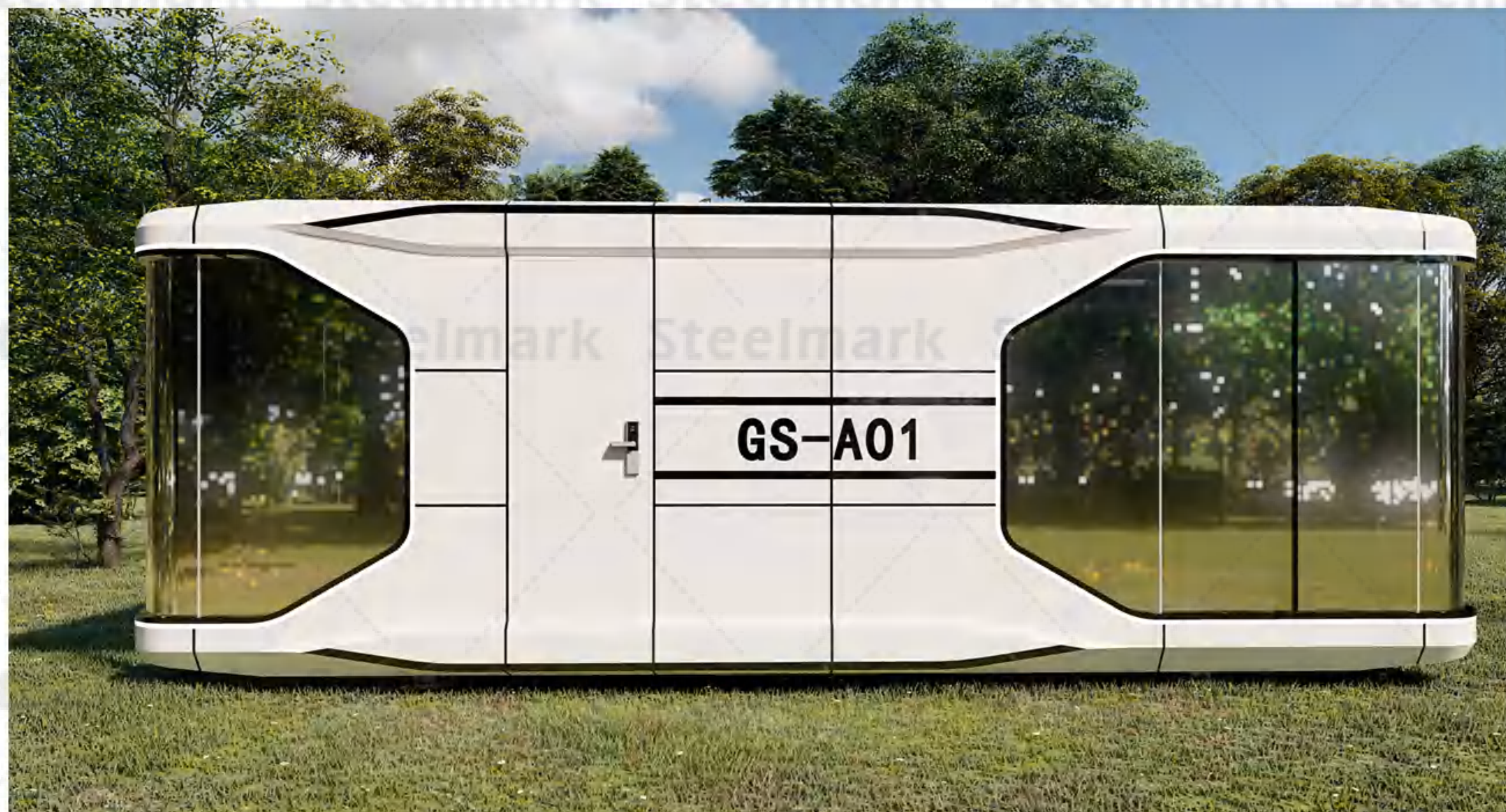



INTERNAL DISPLAY OF THE SPACE CAPSULE



The cabin adopts an open design, and the decoration style and pattern can be customized according to customer requirements.





**INTERNAL DISPLAY OF THE
SPACE CAPSULE**



PRODUCT SERIES

GS-A01

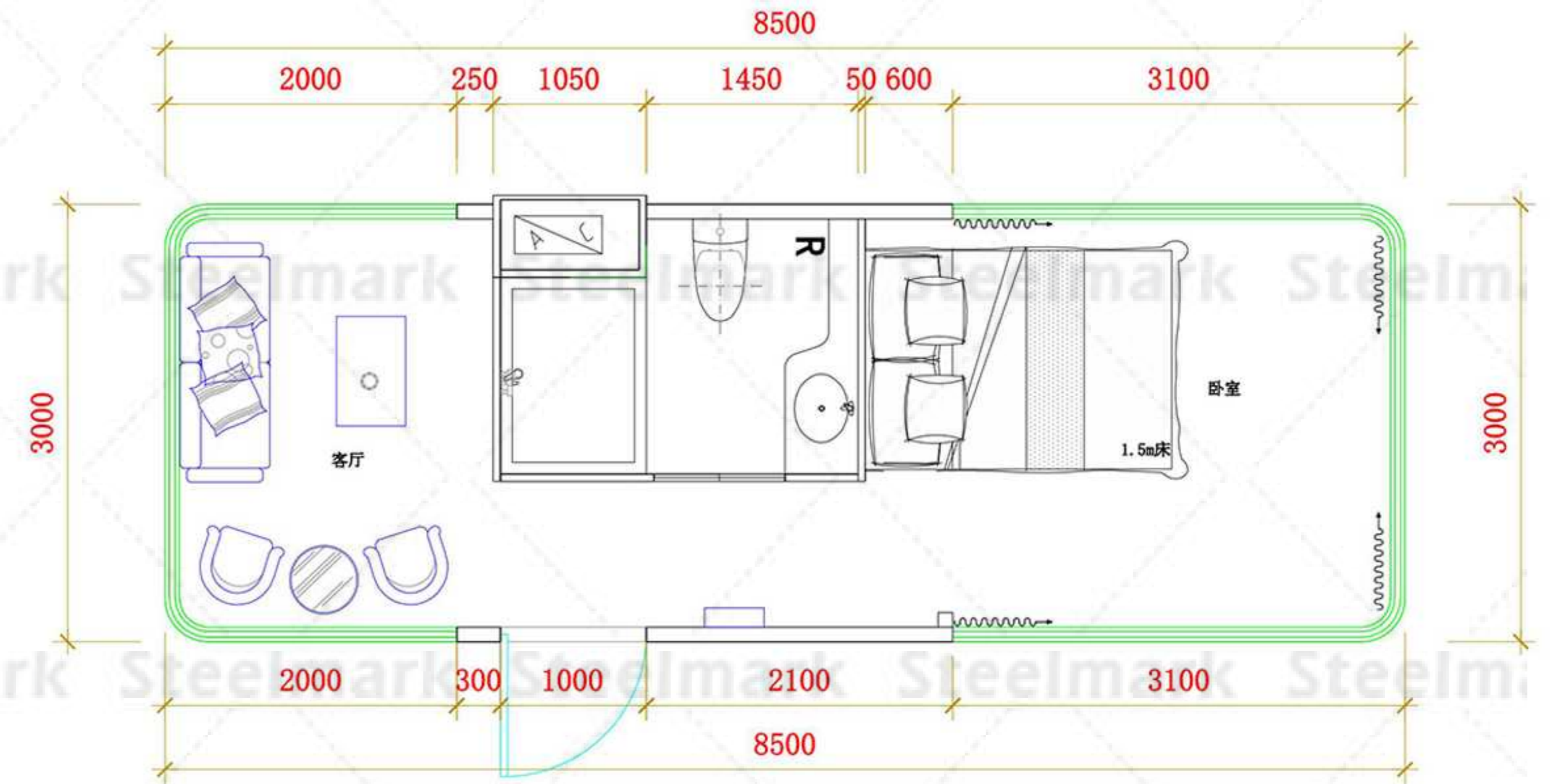

Product printmap

Note: The product continues to be upgraded and iterates.

MODEL	GS-A01 SMART MODEL (1 BEDROOM AND 1 HALL)	MAXIMUM NUMBER	4-6 PEOPLE
DIMENSIONS	L8500mm、W3000mm、H3300mm	MAXIMUM ELECTRICITY	12KW
LAND	27.2m ²	INDOOR GROUND LOAD	500KG/m ²

PRODUCT FEATURES

It can move the space cabin hotel, the strong design of the net red homestay, the panoramic glass floor -to -ceiling windows and skylights, the outdoor is grass and woods, there are style of wild luxury camps, you can picnic with family and friends, enjoy the sunset, especially suitable for taking pictures. Clean, comfortable and comfortable, it is a well -deserved treasure space cabin home!

PHYSICAL DISPLAY OF PRODUCTS





INTERNAL DISPLAY OF THE SPACE CAPSULE

Configure the all-smart home appliance control system, design a panoramic view of the design, bring your own traffic





INTERNAL DISPLAY OF THE SPACE CAPSULE

PRODUCT SERIES

GS-A02



Note: The product continues to be upgraded and iterates.

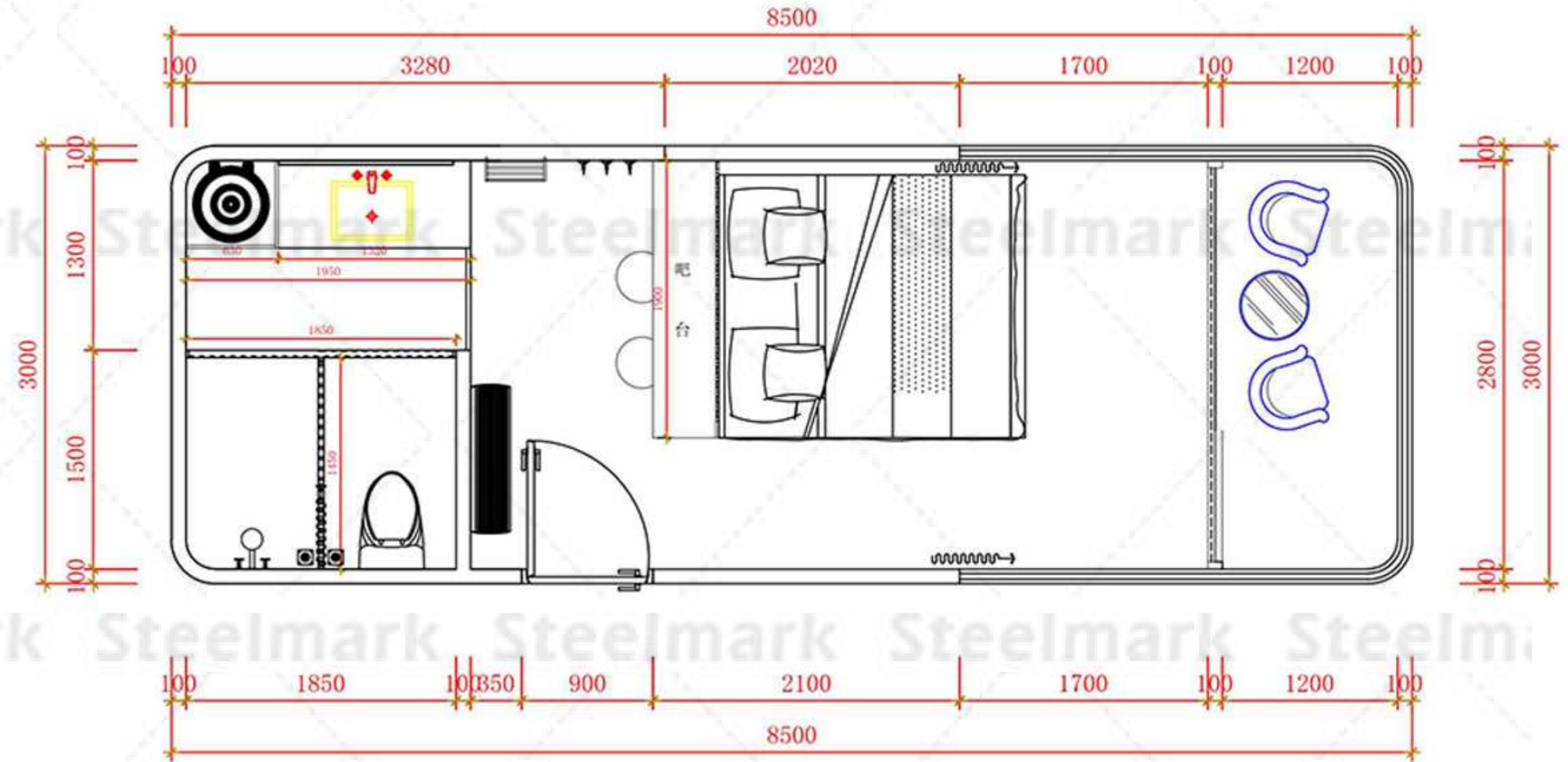

MODEL	GS-A02 (8.5 METERS WITH BALCONY)	MAXIMUM NUMBER	4-6 PEOPLE
DIMENSIONS	L8500mm、W3000mm、H3300mm	MAXIMUM ELECTRICITY	12KW
LAND	27.2m ²	INDOOR GROUND LOAD	500KG/m ²

PRODUCT FEATURES

The national color "space cabin" uses light steel structure assembly, aviation composite integrated material combination, and gives intelligent systems, beautiful shapes, insulation and insulation, especially the "space capsule" floor glass to three layers of hollow coating mirror glass to make "The "space cabin" building is integrated with the surrounding landscapes to form a beautiful landscape.

PHYSICAL DISPLAY OF PRODUCTS



PRODUCT EFFECT DISPLAY

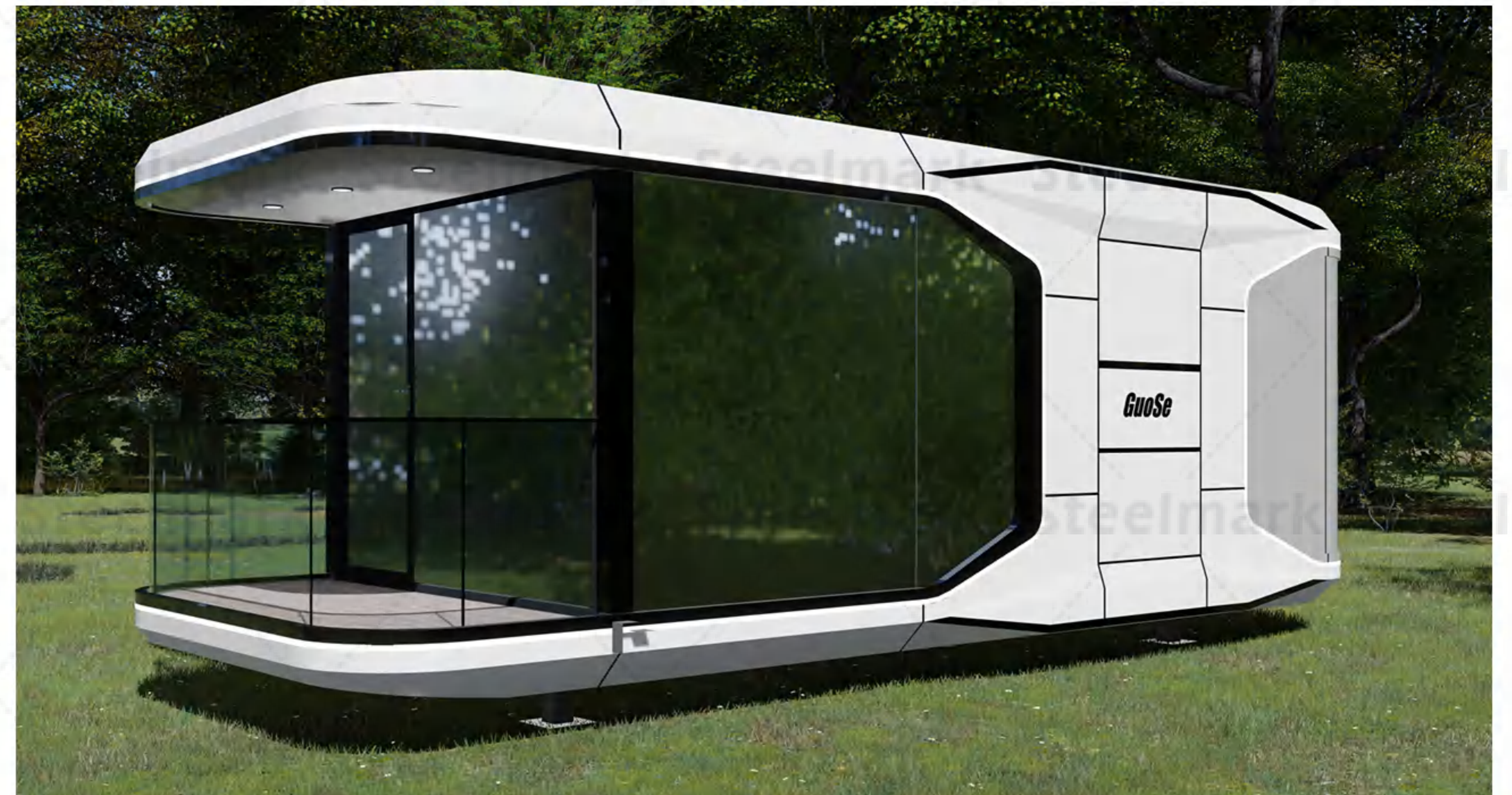



INTERNAL DISPLAY OF THE SPACE CAPSULE

Use healthy and high-quality environmentally friendly materials to build a convenient and fast, breathing green ecological house



PRODUCT SERIES GS-A04



Note: The product continues to be upgraded and iterates.

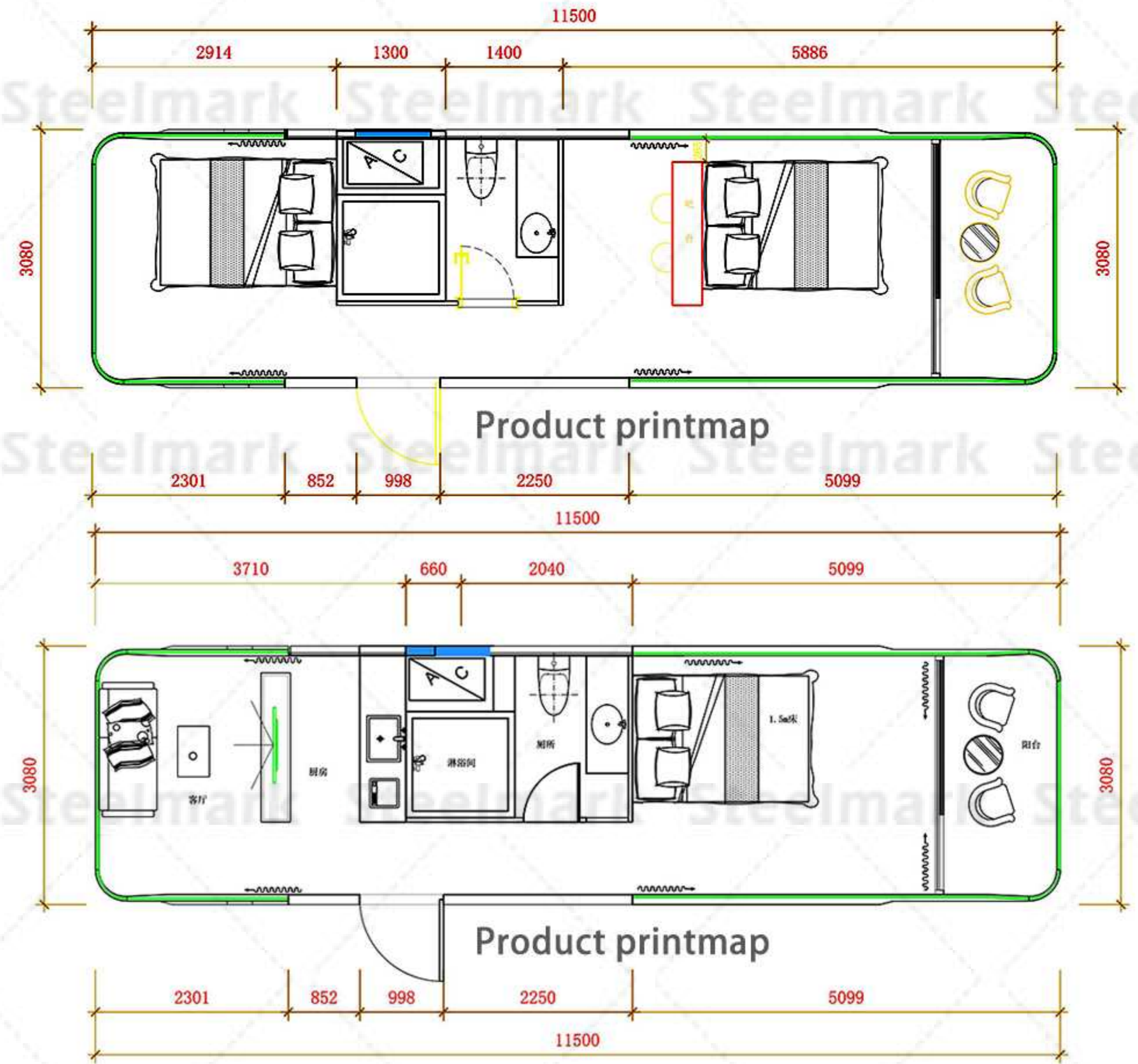

MODEL	GS-A04 (11.5 METERS WITH BALCONY)	MAXIMUM NUMBER	4-6 PEOPLE
DIMENSIONS	L11500mm、W3080mm、H3300mm	MAXIMUM ELECTRICITY	12KW
LAND	35.5m ²	INDOOR GROUND LOAD	500KG/m ²

PRODUCT FEATURES

The national color "space cabin" uses light steel structure assembly, aviation composite integrated material combination, and gives intelligent systems, beautiful shapes, insulation and insulation, especially the "space capsule" floor glass to three layers of hollow coating mirror glass to make "The "space cabin" building is integrated with the surrounding landscapes to form a beautiful landscape.

PHYSICAL DISPLAY OF PRODUCTS



PRODUCT EFFECT DISPLAY

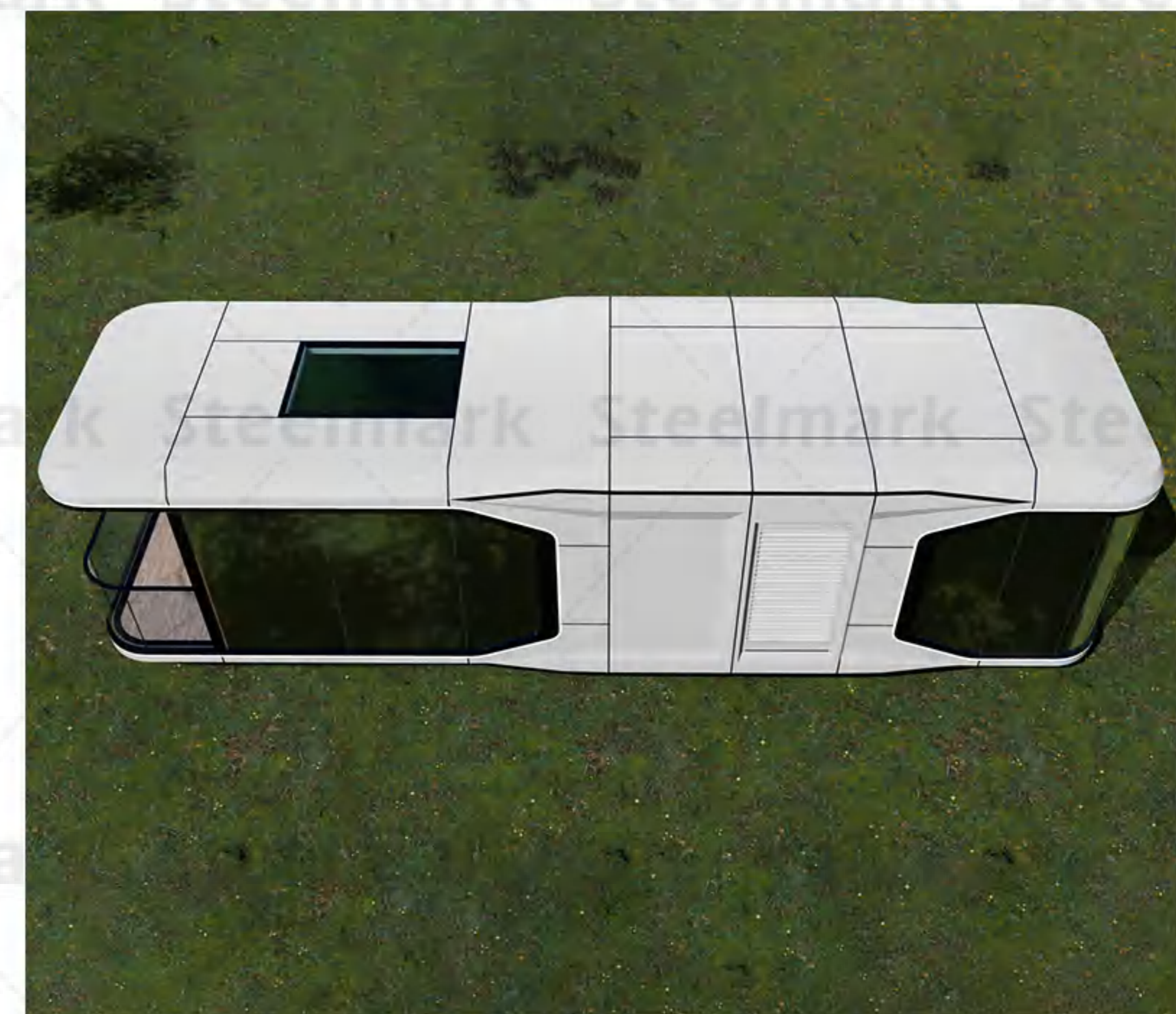



INTERNAL DISPLAY OF THE SPACE CAPSULE

The cabin body adopts open design, decoration style and pattern can be customized according to customer requirements.





INTERNAL DISPLAY OF THE SPACE CAPSULE

The cabin body adopts open design, decoration style and pattern can be customized according to customer requirements.

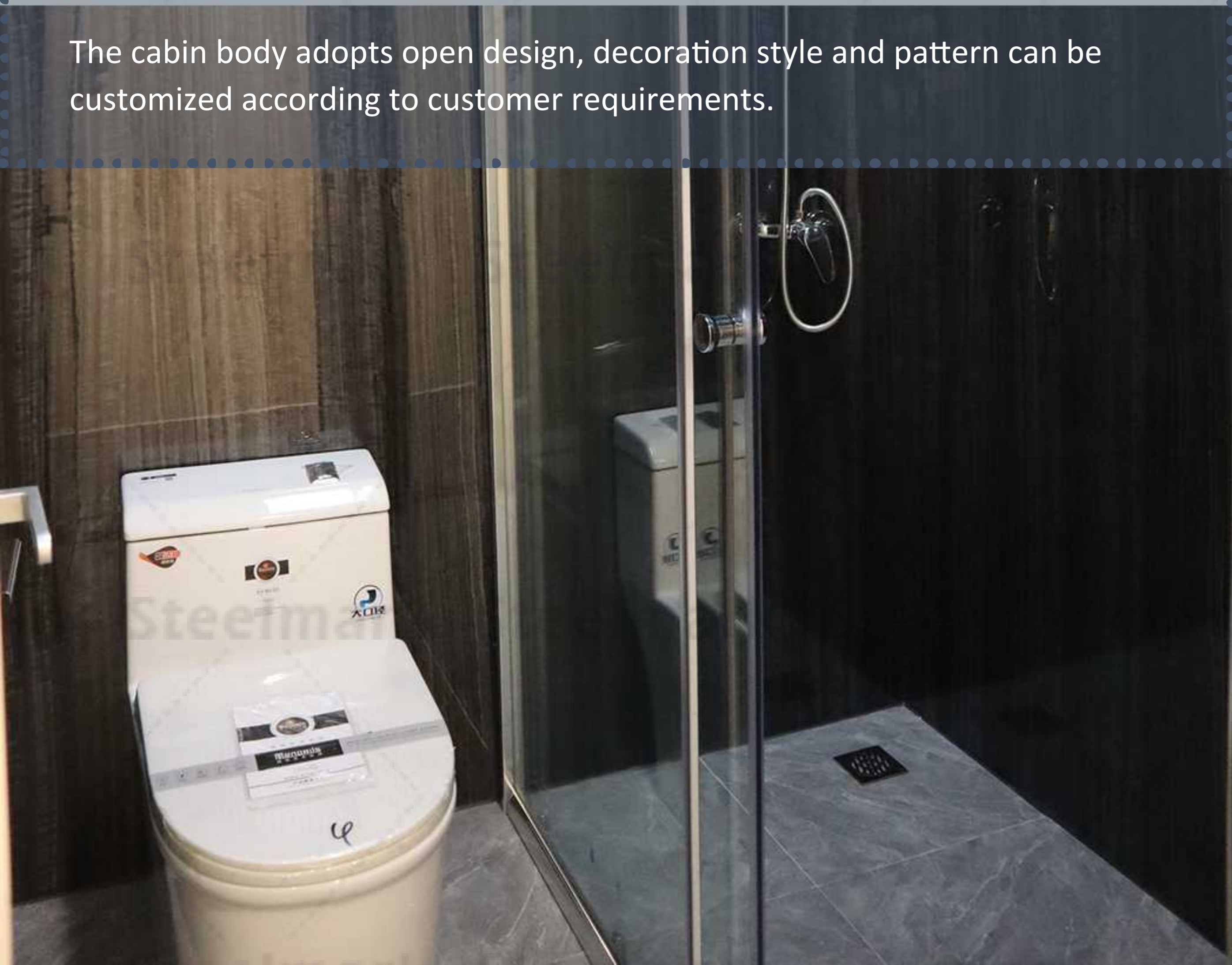

PROJECT PRODUCT PRODUCTION

Steelmark Steelmark Steelmark Steelmark

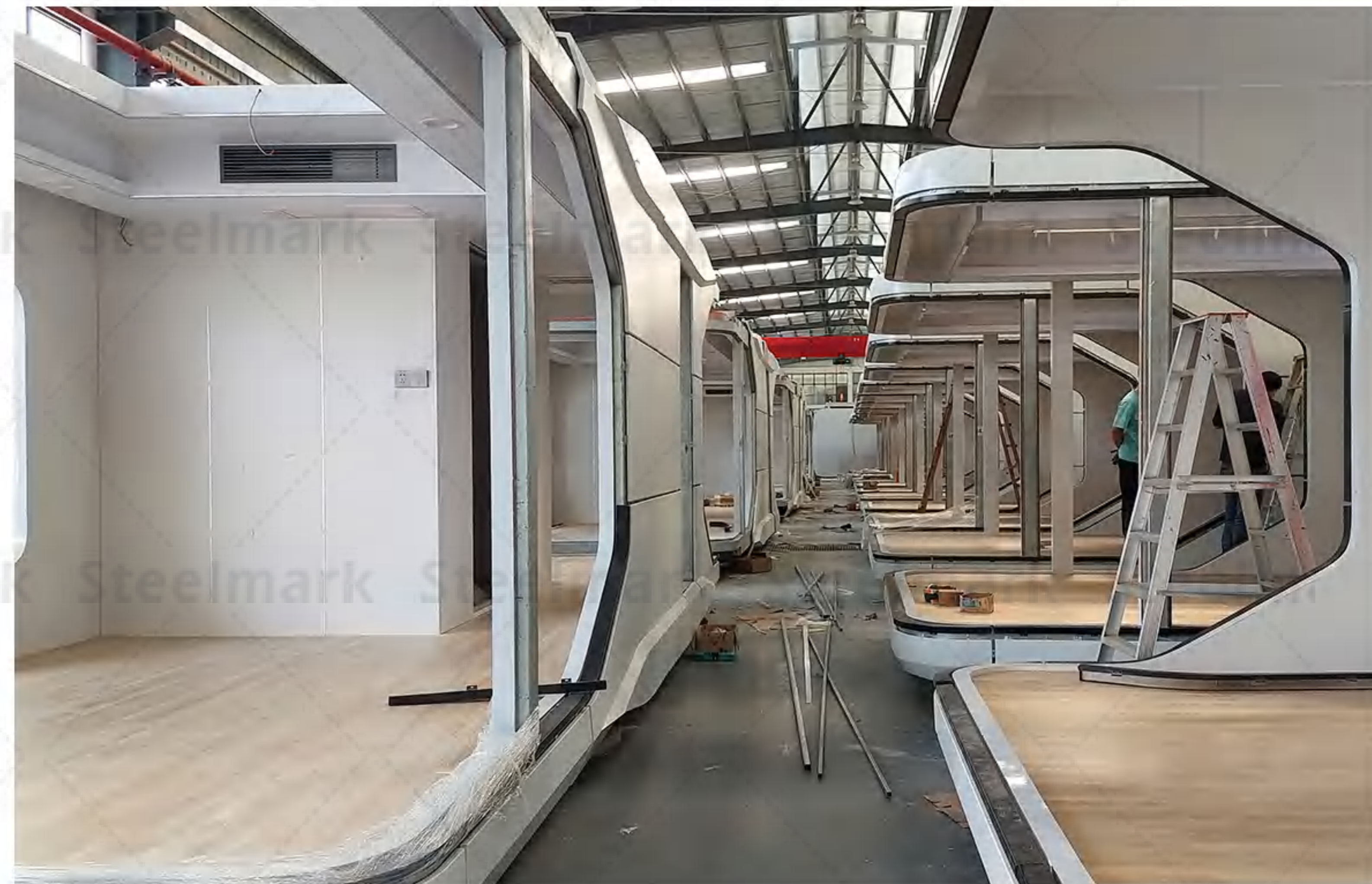

Steelmark Steelmark Steelmark Steelmark Steelmark Steelmark Steelmark Steelmark

PROJECT PRODUCT PRODUCTION

Steelmark Steelmark Steelmark Steelmark Steelmark Steelmark Steelmark Steelmark Steelmark

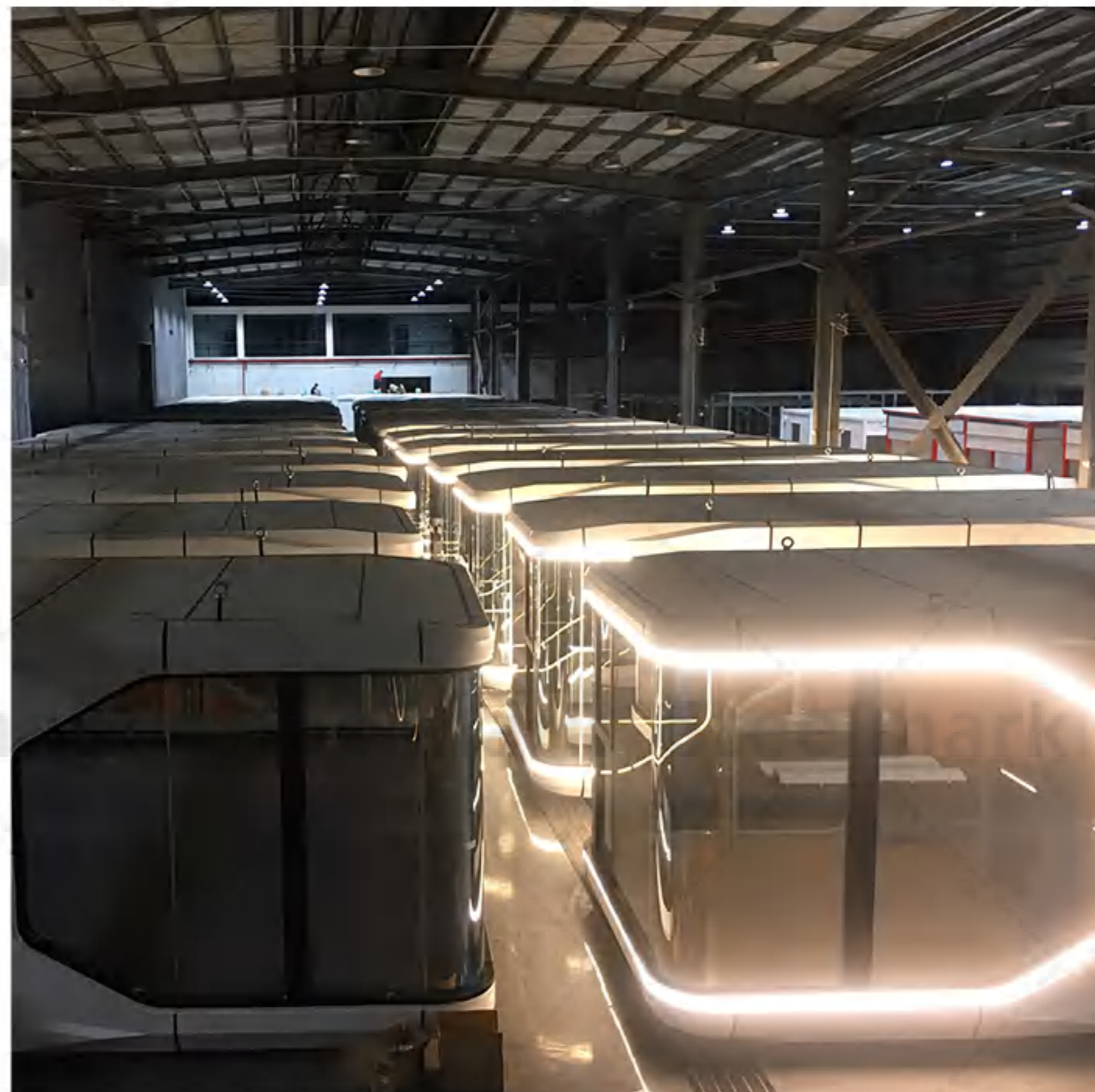

Steelmark Steelmark Steelmark Steelmark Steelmark Steelmark Steelmark Steelmark Steelmark

PROJECT PRODUCT PRODUCTION

Steelmark Steelmark Steelmark Steelmark Steelmark Steelmark Steelmark Steelmark Steelmark



Steelmark Steelmark Steelmark Steelmark Steelmark Steelmark Steelmark Steelmark Steelmark

PACKING AND SHIPPING



SCHEDULED DELIVERY PROCESS

PRODUCTION BASE



Determine the basic conditions and program customer order products

The space capsule and professional design team will design and plan the project site, and make adjustments to local conditions and precise positioning according to users' needs and budgets.



The factory is scheduled to start the production project at the same time the foundation construction

According to customer requirements, arrange the production line of the factory for production, at the same time, inspect the project site, communicate and coordinate with customers, and carry out foundation construction.



Make sure the foundation construction is completed, pay the balance with the customer, and the product is shipped from the factory

After the project foundation construction is completed and the customer pays the balance, the product will be shipped from the factory to the project site.



Installation completed customer acceptance





EX-FACTORY TRANSPORT

After the product external packaging, the use of large flatbed transport truck. Products from the factory to the site of the camp journey, will adopt strict safety protection measures to ensure safety and stability in transport.



PRODUCT LIFTING

After the transportation vehicle reaches the local area, large cranes need to be used for hanging ground. After the product reaches the project area, it is necessary to combine the actual situation of the on-site, use the appropriate hanging equipment, the product design hanging point and provide tonnage data.



MOUNTING BASE

The hardening can be installed directly, and other geological environment will cooperate with the project construction party for infrastructure. The installation of the product base must formulate the foundation excavation construction plan according to soil quality conditions to ensure the safety and stability of the product landing.

PRODUCT TRANSPORTATION AND INSTALLATION



CAPSULE STANDARD PRODUCT CATALOG



**MOBILE PREFAB
VACATION VILLA HOUSE**

Guangzhou Guose Intelligent Technology Co.,Ltd.